

ConnectTM A tube

Endless PossibilitiesTM

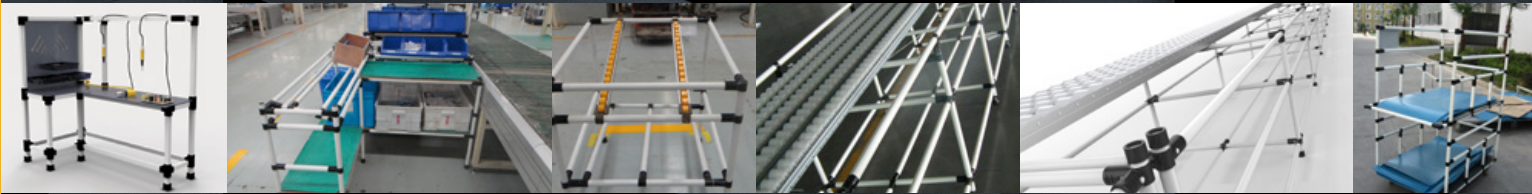

www.connect-a-tube.com

a product by:



TEXAM
design engineering



a product by:

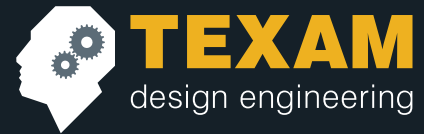

**LIVE STORAGE
SYSTEMS**



**RACKING
& SHELVING**



WORKSTATIONS



**BESPOKE
DESIGNS**



**CARTS &
TROLLEYS**

The Simple Product with Endless Possibilities.

Design and build bespoke pieces of
handling and storage equipment quickly.

www.connect-a-tube.com

Contents

Tubes	05
Metal Joints	09
Metal Joints Sets	13
Metal Accessories	17
Roller Tracks	23
Roller Tracks Guides	27
Mounting Brackets	29
Wheels and Castors	35
Feet	39
Caps and Bushings	42
Fasteners	44
Construction Guide	47



Fully Customisable

Standard roller tracks can be added to quickly build conveyors or live storage equipment. Castors can also be fitted to construct mobile equipment. A complete range of standard parts can be used that allows the user to construct exactly what's needed in a quick and very cost effective manner.



Flexible and Reuseable

All Connect-A-tube parts are re-usable time and time again meaning that the overall cost of ownership is reduced and new equipment can quickly be reassembled to suit the changing needs of your business.



Space Saving

Connect-A-tube is also a space saving product as bespoke equipment can be constructed to fit exactly where you want it to go. How many times have you had to settle for something that was either 'too big', 'too small', or 'almost right'. With Connect-A-tube you can build exactly what you need to do exactly the job you want it to do.

Connect A tube™

Quickly Assembled, Cost Effective and Ergonomical.

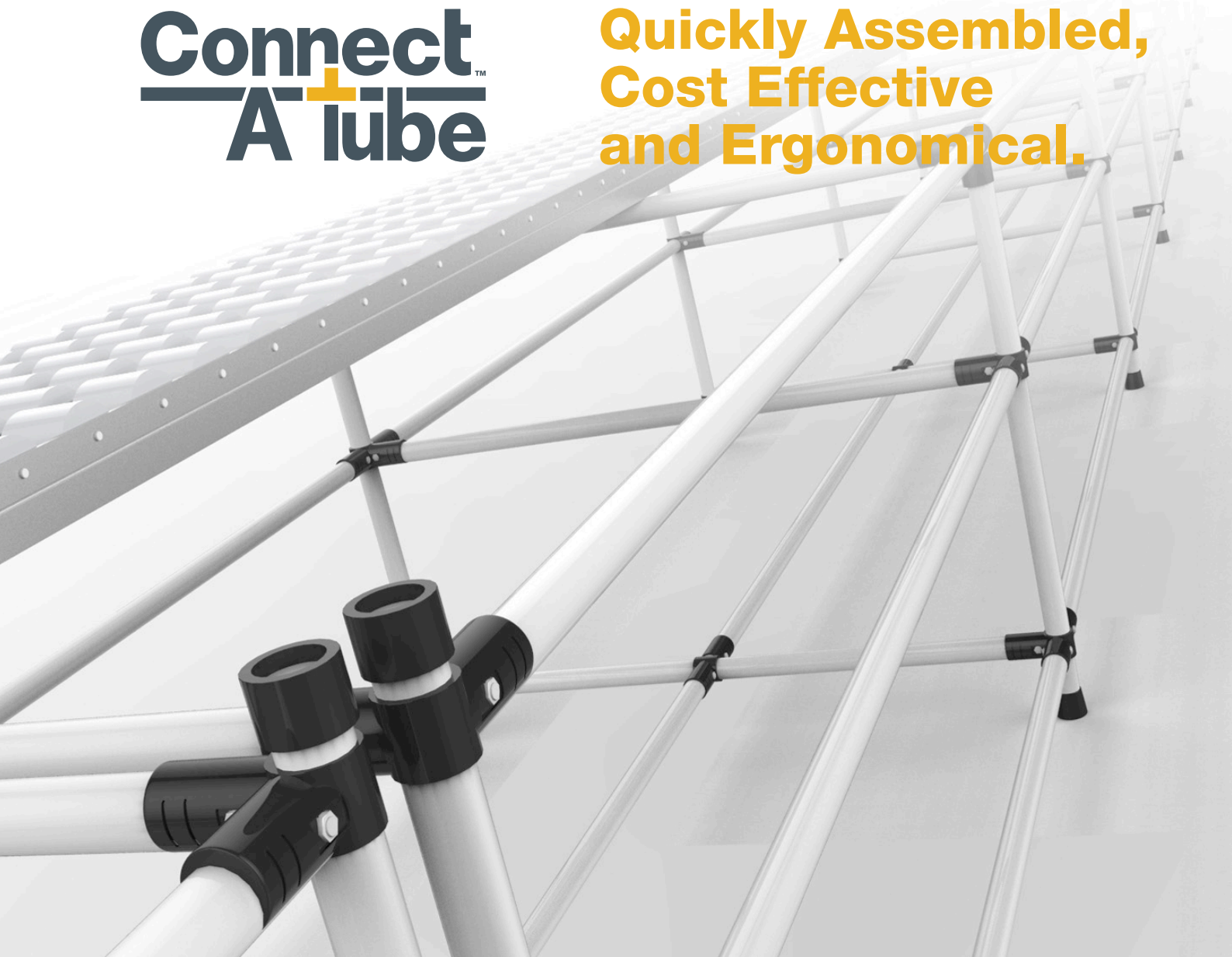

Product Overview

Should your manufacturing process change for any reason minor modifications can be carried out immediately. If a major process change is required all of the equipment can be deconstructed and reassembled to suit your new process. Ultimately nothing is wasted and new equipment, proto-types etc can be assembled and ready to test in just a few hours.

The graphic illustrations are just a few ideas of what can be made with Texam Connect-A-Tube®. Our design teams will be pleased to assist in the design of new equipment and ensure that everything is mechanically strong enough to do the job using some basic principles of proper construction.

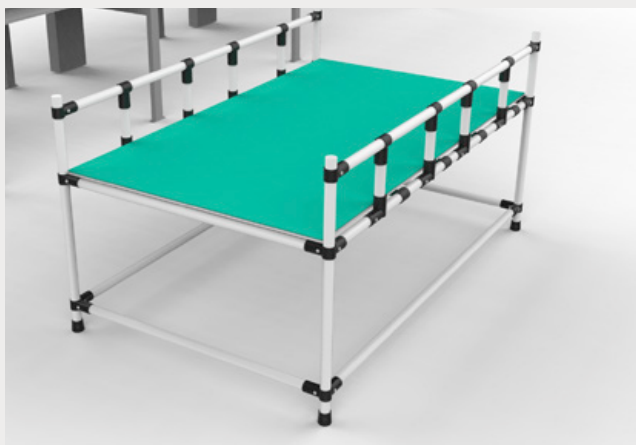

www.connect-a-tube.com



Connect
A tube











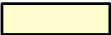

Tubes

a product by:



TEXAM
design engineering

ABS COATED PIPE – COLOUR TABLE

CLASSIFICATION		STANDARD PIPE			SLIDE PIPE	FLAT PIPE	
STANDARD							
COLOUR		Ø28 x T0.7	Ø28 x T1.0	Ø28 x T2.0	Ø28 x T1.0	Ø28 x T0.7	Ø28 x T1.0
IVORY (IV)		●	●	●	●	●	●
GREEN (GR)		●	●	●	●	—	—
DARK BLUE (DB)		●	●	●	●	—	—
LIGHT BLUE (LB)		●	●	●	●	—	—
LIGHT GREY (LG)		●	●	●	●	—	—
DARK GREY (DG)		●	●	●	—	●	●
BLACK (BK)		●	●	●	●	—	—
RED (RE)		●	●	●	●	—	—
YELLOW (YE)		●	●	●	●	—	—
WHITE (WH)		●	●	●	—	●	●
ESD BLACK (EB)		●	●	●	●	●	●
LINE ESD (LI)		●	●	—	—	—	—

*STANDARD LENGTH = 4000MM

STAINLESS STEEL PIPE – COLOUR TABLE

CLASSIFICATION		STANDARD PIPE			SLIDE PIPE	FLAT PIPE	
STANDARD							
COLOUR		Ø28 x T0.7	Ø28 x T1.2	Ø28 x T2.0	Ø28 x T1.0	Ø28 x T0.7	Ø28 x T1.0
STAINLESS STEEL (SS)		●	●	—	—	—	—



Ivory Black White Light Blue Dark Blue

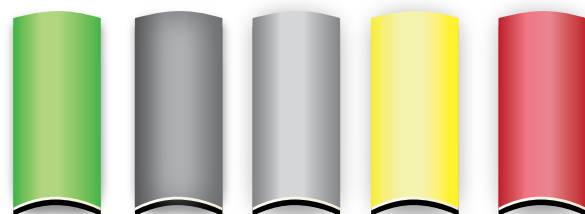

Green Dark Grey Light Grey Yellow Red

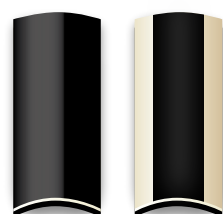

ESD Black Line ESD

POWDER COATED PIPE – COLOUR TABLE			
CLASSIFICATION		STANDARD PIPE	
COLOUR	STANDARD	STANDARD PIPE	
		Ø28 x T0.7	Ø28 x T1.0
IVORY (IV)			
GREEN (GR)			
DARK BLUE (DB)			
LIGHT BLUE (LB)			
LIGHT GREY (LG)			
DARK GREY (DG)			
BLACK (BK)			
RED (RE)			
YELLOW (YE)			
WHITE (WH)			
ESD BLACK (EB)			
LINE ESD (LI)			

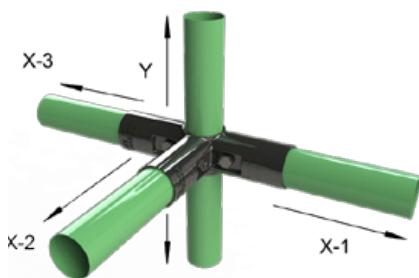

NUMBERING SYSTEM

CLASSIFICATION	ITEM	PART NO		STEEL THICKNESS	WEIGHT PER PC	TYPE
		COATED	ESD PIPE			
PLASTIC COATED PIPE	STANDARD PIPE	CP2807 - X	ECP2807 - X	Ø28 x T0.7	2,050 KG	
		CP2810 - X	ECP2810 - X	Ø28 x T1.0	2,750 KG	
		CP2820 - X	ECP2820 - X	Ø28 x T2.0	4,400 KG	
	SLIDE PIPE	SP2810 - X	ESP2810 - X	Ø28 x T1.0	3,000 KG	
	FLAT PIPE	FP2807 - X	EFP2807 - X	Ø28 x T0.7	2,300 KG	
		FP2807 - X	EFP2807 - X	Ø28 x T1.0	3,050 KG	
	LINE PIPE ESD	-	ECP2807 - LI	Ø28 x T0.7	2,050 KG	
		-	ECP2810 - LI	Ø28 x T1.0	2,750 KG	
PWDER COATED PIPE	STANDARD PIPE	PP2808 - X	ECP2808 - X	Ø28 x T0.8	2,200 KG	
		PP2812 - X	EPP2812 - X	Ø28 x T1.2	3,300 KG	
STAINLESS STEEL PIPE	-	SSP2807		Ø28 x T0.7	1,800 KG	
		SSP2812		Ø28 x T1.2	3,300 KG	

COLOUR CODE NUMBERING SYSTEM FOR COATED PIPES

CP - 2807 - X		
PIPE	STEEL THICKNESS	COLOUR CODE
CP = ABS pipe SP = ABS slide pipe FP = ABS flat pipe ECP = ABS pipe (ESD) ESP = ABS slide pipe (ESD) EFP = ABS flat pipe (ESD) PP = Powder coated pipe EPP = Powder coated pipe (ESD)	07 = t0.7 10 = t1.0 12 = t1.2 20 = t2.0	IV = IVORY GR = GREEN DB = DARK BLUE LB = LIGHT BLUE LG = LIGHT GREY DG = DARK GREY BK = BLACK RE = RED YE = YELLOW WH = WHITE EG = ESD GREY EB = ESD BLACK LI = LINE ESD
EXAMPLE: ABS COATED PIPE, DARK BLUE, Ø28 x T1.0 = CP2810-DB. OTHER COLOURS ON REQUEST.		



Connect
A tube

Metal Joints

a product by:



TEXAM
design engineering

E - 1 [90° BUTT JOINT]

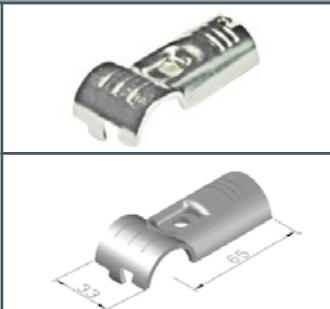

Weight per pc: 0,067kg / Quantity per box: 330pcs

E - 1C [OPEN 90° BUTT JOINT]



Weight per pc: 0,062kg / Quantity per box: 330pcs

E - 2 [INNER ELBOW]

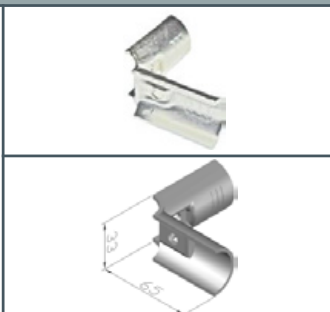

Weight per pc: 0,097kg / Quantity per box: 230pcs

E - 3 [OUTER ELBOW]

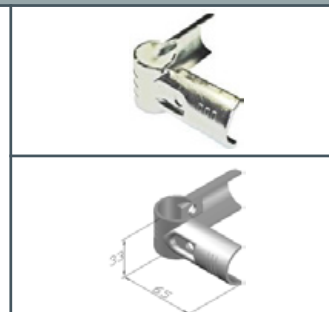

Weight per pc: 0,124kg / Quantity per box: 100pcs

E - 4 [180° FLAT JOINT]

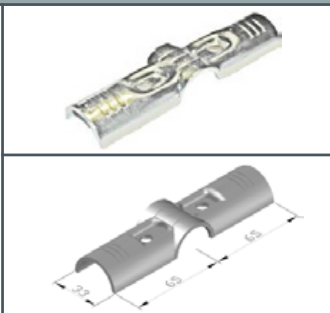

Weight per pc: 0,111kg / Quantity per box: 240pcs

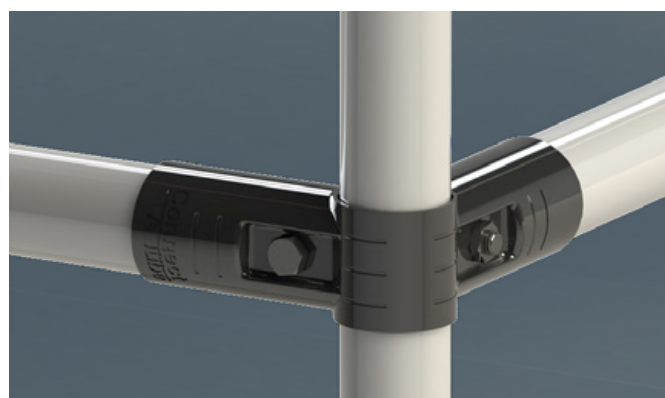

E - 6 [CROSSOVER JOINT]

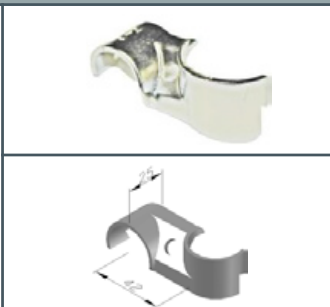
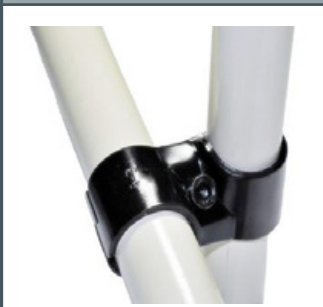

Weight per pc: 0,049kg / Quantity per box: 250pcs

E - 6C [OPEN CROSSOVER JOINT]

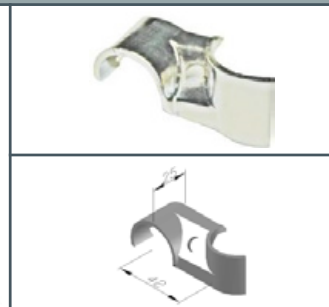

Weight per pc: 0,044kg / Quantity per box: 250pcs

E - 7A [VARIABLE ANGLE JOINT]



Weight per pc: 0.048kg / Quantity per box: 450pcs

E - 7B [VARIABLE ANGLE JOINT]



Weight per pc: 0.060kg / Quantity per box: 360pcs

E - 8 [PARALLEL JOINT]



Weight per pc: 0.054kg / Quantity per box: 360pcs

E - 9 [DOUBLE BUTT JOINT]

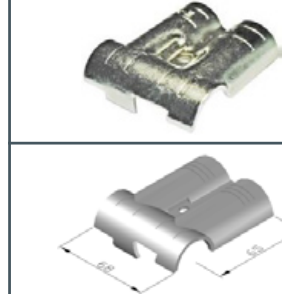

Weight per pc: 0.133kg / Quantity per box: 150pcs

E - 11 [ROUNDED CORNER JOINT]



Weight per pc: 0.104kg / Quantity per box: 200pcs

E - 12 [SLIDING BUTT JOINT]



Weight per pc: 0.062kg / Quantity per box: 270pcs

E - 13A [45° DIAGONAL JOINT]

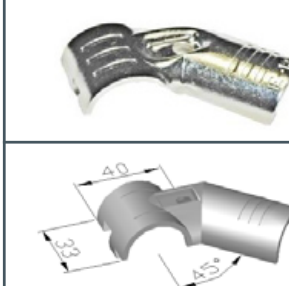

Weight per pc: 0.073kg / Quantity per box: 240pcs

E - 13B [45° DIAGONAL JOINT]



Weight per pc: 0.073kg / Quantity per box: 240pcs

E - 14 [DOUBLE VARIABLE ANGLE JOINT]



Weight per pc: 0,057kg / Quantity per box: 300pcs

E - 15A [MULTI-PURPOSE JOINT]



Weight per pc: 0,038kg / Quantity per box: 840pcs

E - 16 [MULTI-PURPOSE JOINT]



Weight per pc: 0,048kg / Quantity per box: 450pcs

E - 18 [SLIDING PARALLEL JOINT]



Weight per pc: 0,054kg / Quantity per box: 300pcs



E - 15B [MULTI-PURPOSE JOINT]



Weight per pc: 0,041kg / Quantity per box: 420pcs

E - 17 [SLIDING PARALLEL JOINT]



Weight per pc: 0,050kg / Quantity per box: 300pcs

E - 20 [FLAT PIPE CLAMP]

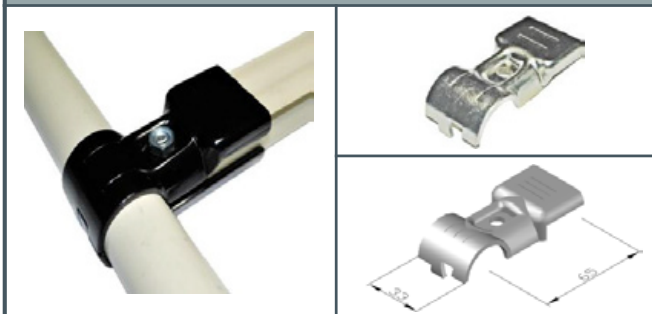

Weight per pc: 0,070kg / Quantity per box: 300pcs



Connect
A tube

Metal Joints Sets

a product by:



TEXAM
design engineering

ES - 1 - BK / NI

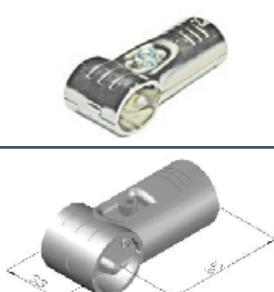

● E-1-BK/NI x 2 ● M0625 x 1 ● TN06 x 1

ES - 1C - BK / NI

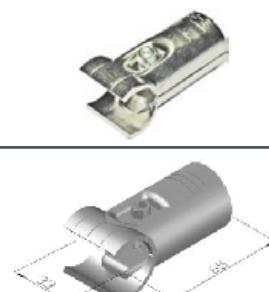

● E-1C-BK/NI x 2 ● M0625 x 1 ● TN06 x 1

ES - 2 - BK / NI

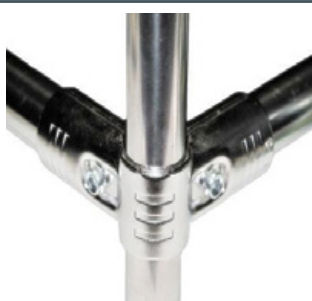

● E-2-BK/NI x 1 ● E-3-BK/NI x 1 ● M0625 x 2 ● TN06 x 2

ES - 3 - BK / NI

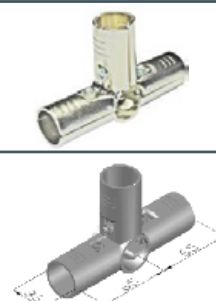
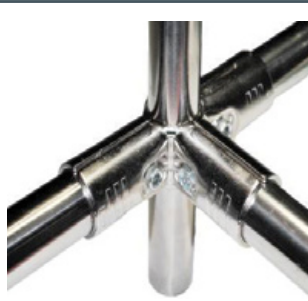

● E-2-BK/NI x 2 ● E-4-BK/NI x 1 ● M0625 x 3 ● TN06 x 3

ES - 4 - BK / NI

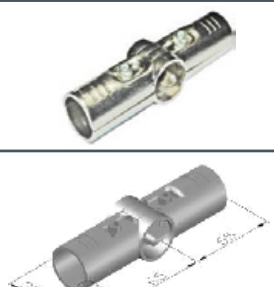

● E-4-BK/NI x 2 ● M0625 x 2 ● TN06 x 2

ES - 5 - BK / NI

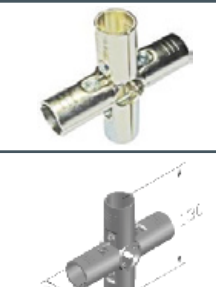

● E-2-BK/NI x 4 ● M0625 x 4 ● TN06 x 4

ES - 6 - BK / NI

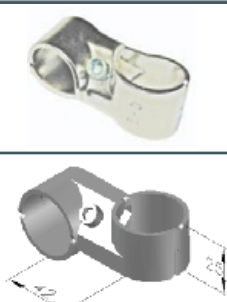

● E-6-BK/NI x 2 ● M0625 x 1 ● TN06 x 1

ES - 6C - BK / NI

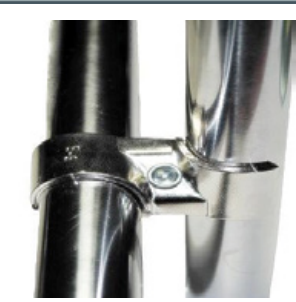

● E-6C-BK/NI x 2 ● M0625 x 1 ● TN06 x 1

ES - 7- BK / NI



● E-7A-BK/NI× 2 ● E-7B-BK/NI× 2 ● M0625× 2 ● TN06× 2

ES - 8 - BK / NI



● E-8-BK/NI× 2 ● M0625× 1 ● TN06× 1

ES - 9 - BK / NI



● E-9-BK/NI× 2 ● M0625× 1 ● TN06× 1

ES - 11 - BK / NI



● E-11-BK/NI× 2 ● M0625× 2 ● TN06× 2



ES - 12 - BK / NI



● E-12-BK/NIx 2 ● GAP-12x 1 ● M0625x 1 ● TN06x 1

ES - 13 - BK / NI



● E-13A-BK/NIx 1 ● E-13B-BK/NIx 1 ● M0625x 1 ● TN06x 1

ES - 14 - BK / NI

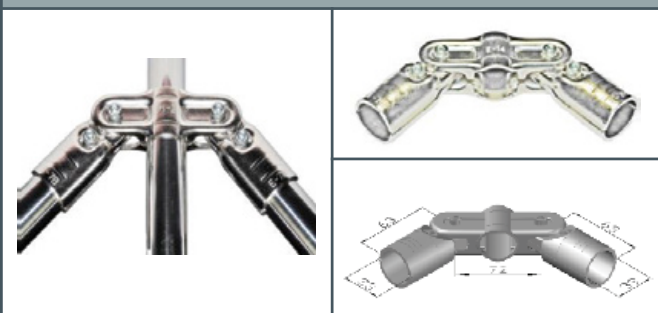

● E-14-BK/NIx 2 ● E-7B-BK/NIx 4 ● M0625x 4 ● TN06x 4

ES - 15 - BK / NI



● E-15A-BK/NIx 1 ● E-15B-BK/NIx 1 ● M0610x 1 ● TN06x 1

ES - 16 - BK / NI



● E-16-BK/NIx 2 ● SC-2x 2

ES - 17 - BK / NI



● E-17-BK/NIx 2 ● GAP-12x 1 ● M0625x 1 ● TN06x 1

ES - 18 - BK / NI



● E-18-BK/NIx 2 ● GAP-12x 2 ● M0625x 1 ● TN06x 1

ES - 20 - BK / NI



● E-1-BK/NIx 1 ● E-20-BK/NIx 1 ● M0625x 1 ● TN06x 1

Connect
A tube

Metal Accessories

a product by:



TEXAM
design engineering

PC – A [PIPE CLAMP]

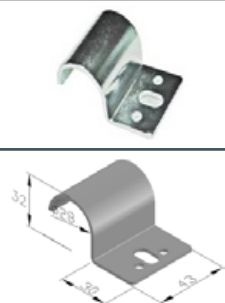
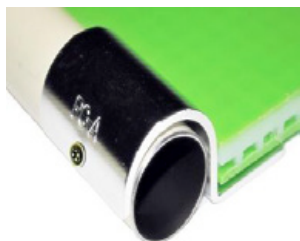

Weight per pc: 0,077kg / Quantity per box: 200pcs

PC – B [PIPE CLAMP]

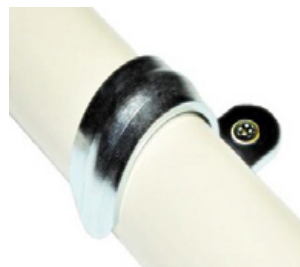

Weight per pc: 0,020kg / Quantity per box: 500pcs

PC – C [PIPE CLAMP]



Weight per pc: 0,023kg / Quantity per box: 500pcs

PC – D [PIPE CLAMP, QUICK RELEASE]



Weight per pc: 0,125kg / Quantity per box: 50pcs

PC – F [BOARD FIXNG]

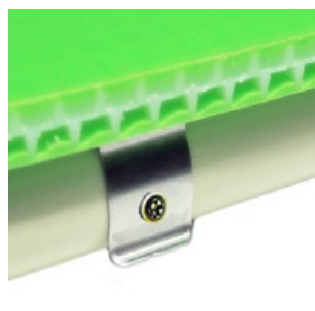

Weight per pc: 0,11kg / Quantity per box: 500pcs



PR – A [PIPE REST]

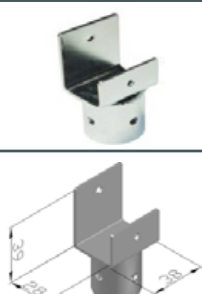

Weight per pc: 0,118kg / Quantity per box: 100pcs

PR – B [PIPE REST]



Weight per pc: 0,146kg / Quantity per box: 80pcs

P – CON – A [PIPE CONNECTOR]



Weight per pc: 0.073kg / Quantity per box: 140pcs

P – CON – B [PIPE CONNECTOR]



Weight per pc: 0.073kg / Quantity per box: 140pcs

SA – S [SHOCK ABSORBER SUPPORT]



Weight per pc: 0.116kg / Quantity per box: 150pcs

SA [SHOCK ABSORBER]



Weight per pc: 0.214kg / Quantity per box: 50pcs

DM – A [DIVIDING METAL A]

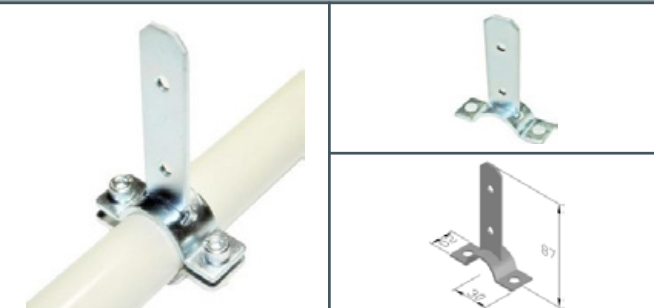

Weight per pc: 0.073kg / Quantity per box: 200pcs

DM – B [DIVIDING METAL B]

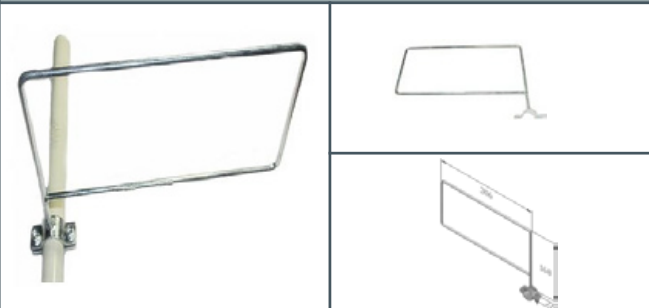

Weight per pc: 0.224kg / Quantity per box: 100pcs

CS – 28L [CORNER SUPPORT L]

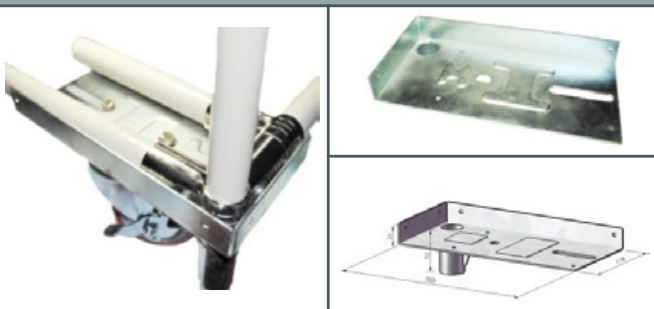

Weight per pc: 0.750kg / Quantity per box: 25pcs

CS – 28R [CORNER SUPPORT R]

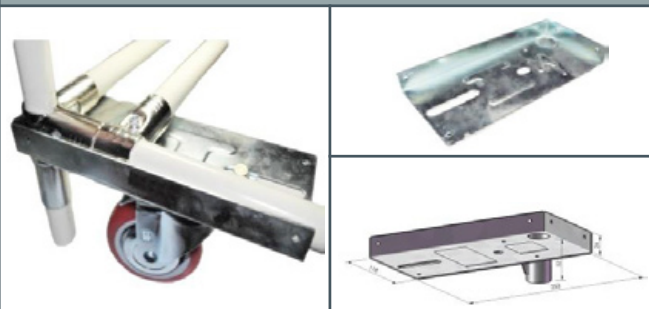

Weight per pc: 0.750kg / Quantity per box: 25pcs

CM – 100 [ATTACHING STRIP FOR PLATE TYPE WHEELS]



Weight per pc: 0.111kg / Quantity per box: 200pcs

CM – 200 [ATTACHING STRIP FOR PLATE TYPE WHEELS]



Weight per pc: 0.116kg / Quantity per box: 150pcs

CM – A [BOARD CORNER SUPPORT A]

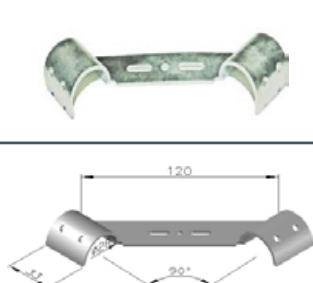

Weight per pc: 0.104kg / Quantity per box: 100pcs

CM – B [BOARD CORNER SUPPORT B]

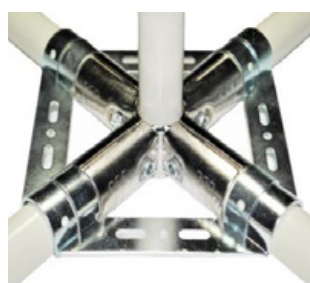

Weight per pc: 0.069kg / Quantity per box: 100pcs

CM – C [CORNER BUMPER METAL]

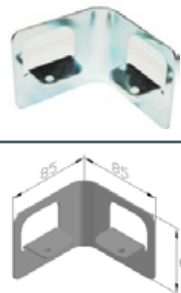

Weight per pc: 0.175kg / Quantity per box: 40pcs

SR – 1 [SLIDE RAIL 35 X 202MM]

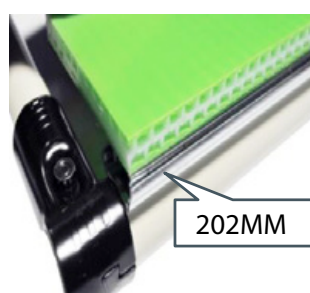

Weight per pc: 0.232kg / Quantity per box: 100pcs

SR 2 [SLIDE RAIL 35 X 240MM]

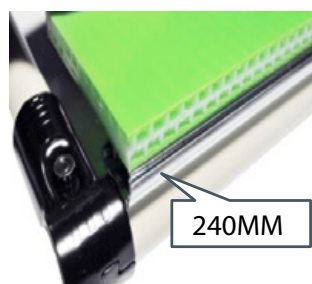

Weight per pc: 0.280kg / Quantity per box: 100pcs

SR – 3 [SLIDE RAIL 35 X 300MM]

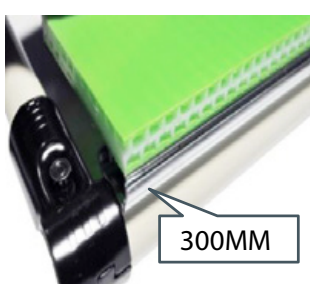

Weight per pc: 0.320kg / Quantity per box: 100pcs

TB300 [Tilt Bar 300 mm]

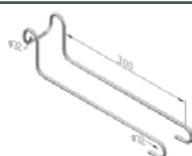

Weight per pc: 0.184kg / Quantity per box: 60pcs

TB400 [Tilt Bar 400 mm]

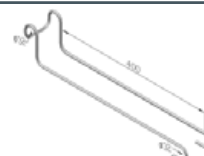
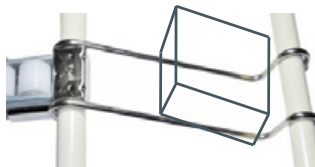

Weight per pc: 0.270kg / Quantity per box: 60pcs

PR - L

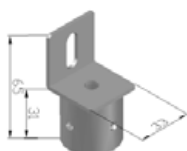
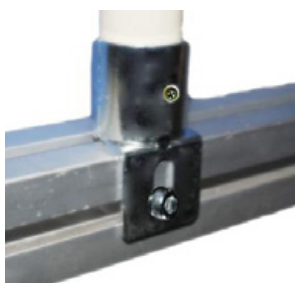

Weight per pc: 0.085kg / Quantity per box: 200pcs

PR - S

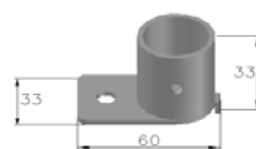

Weight per pc: 0.085kg / Quantity per box: 200pcs

TH50Y - A [TOOL HOLDER]



Weight per pc: 0.220kg / Quantity per box: 50pcs

REH - A [REAR HAUL RING A]

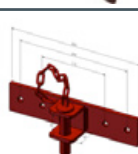

Weight per pc: 4.000kg / Quantity per box: 10pcs

VOS- A [SHUTTING HANGING METAL]

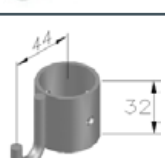

Weight per pc: 0.068kg / Quantity per box: 150pcs

VOS- B [SHUTTING LINK METAL]

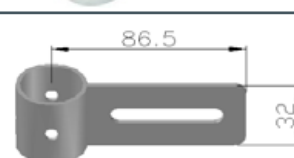

Weight per pc: 0.092kg / Quantity per box: 150pcs

BH – A [BAND HOOK]



Weight per pc: 0.002kg / Quantity per box: 1000pcs

BH – B [BAND HOOK]



Weight per pc: 0.001kg / Quantity per box: 1000pcs

PH – A [HOOK]



Weight per pc: 0.006kg / Quantity per box: 500pcs



EWS – A [ROLLER TRACK BRAKE]

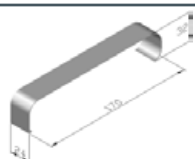

Weight per pc: 0.038kg / Quantity per box: 800pcs

EWS – B [ROLLER TRACK BRAKE]

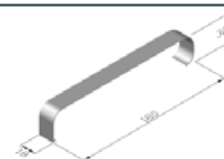

Weight per pc: 0.033kg / Quantity per box: 800pcs

FH – A [TOW BAR]

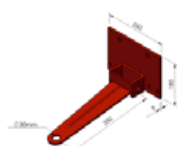

Weight per pc: 5.000kg / Quantity per box: 5pcs

FH – B [TOW BAR]

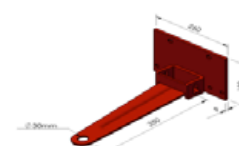

Weight per pc: 6.000kg / Quantity per box: 5pcs

Connect
A tube

Roller Tracks

a product by:



TEXAM
design engineering

*STANDARD LENGTH = 4000MM

RT - 40B / RT - 40B - ESD



- COLOR = WHITE, BLACK
- LOAD CAPACITY = 150 KG
- ROLLER DIAMETER = 34 MM
- SHAFT DIAMETER = 4MM
- ROLLER PITCH = 36MM
- GALVANISED STEEL(SPCC) / PE

RT - 40C / RT - 40C - ESD

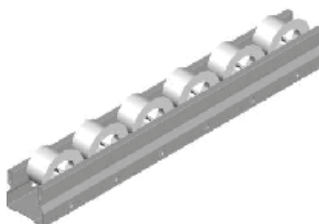

- COLOR = WHITE, BLACK
- LOAD CAPACITY = 150 KG
- ROLLER DIAMETER = 43 MM
- SHAFT DIAMETER = 4MM
- ROLLER PITCH = 45MM
- GALVANISED STEEL(SPCC) / PE

RT - 85A

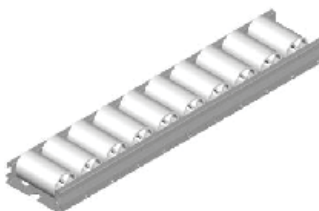
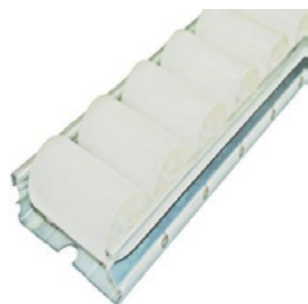

- COLOR = WHITE
- LOAD CAPACITY = 300 KG
- ROLLER DIAMETER = 45 MM
- SHAFT DIAMETER = 5 MM
- ROLLER PITCH = 50 MM
- GALVANISED STEEL(SPCC) / PE

*STANDARD LENGTH = 4000MM

RT - 40BQ / RT - 40BQ - ESD

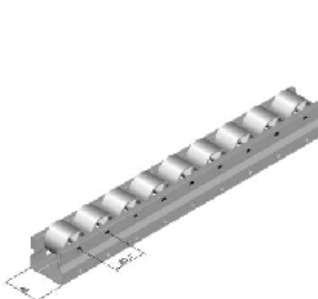
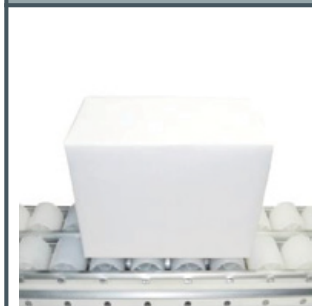

- COLOR = WHITE, BLACK
- LOAD CAPACITY = 150 KG
- ROLLER DIAMETER = 34 MM
- SHAFT DIAMETER = 4MM
- ROLLER PITCH = 36MM
- GALVANISED STEEL(SPCC) / PE

RT - 40CQ / RT - 40CQ - ESD

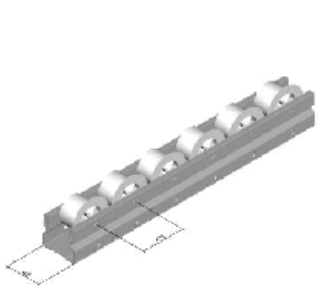

- COLOR = WHITE, BLACK
- LOAD CAPACITY = 150 KG
- ROLLER DIAMETER = 43 MM
- SHAFT DIAMETER = 4MM
- ROLLER PITCH = 45MM
- GALVANISED STEEL(SPCC) / PE

RT - 40S / RT - 40S - ESD

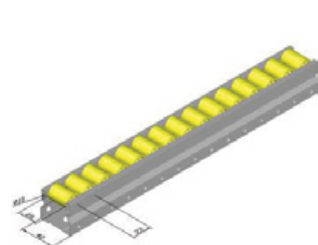

- COLOR = WH,BK,RE,YE
- LOAD CAPACITY = 150KG
- ROLLER DIAMETER = 16MM
- SHAFT DIAMETER = 4MM
- ROLLER PITCH = 22MM
- GALVANISED STEEL(SPCC) / PE

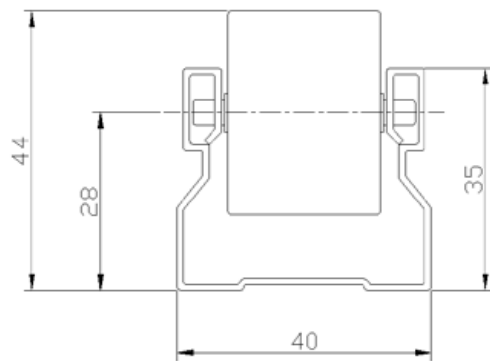

RT - 40B - WHITE

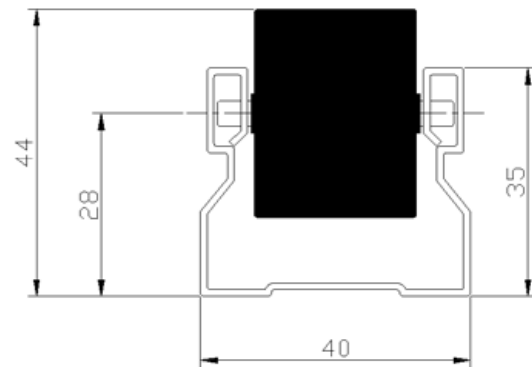

RT - 40B - BLACK

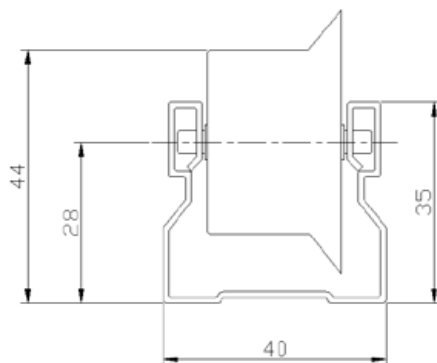

RT - 40C - WHITE

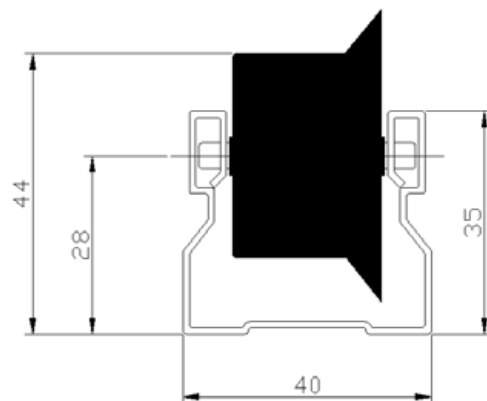

RT - 40C - BLACK

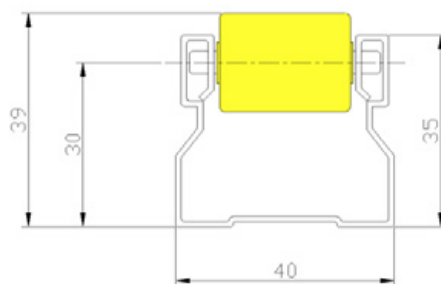

RT - 40S - YELLOW

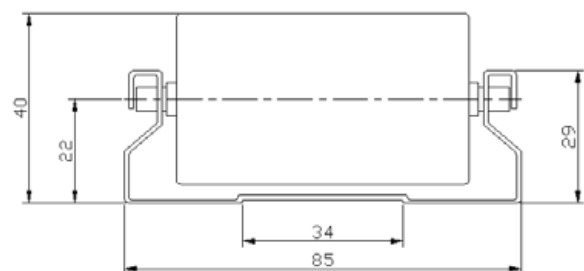

RT - 85A - WHITE



Roller Tracks Guides

a product by:



TEXAM
design engineering

RTG - 1 [ROLLER TRACK GUIDE SIDE, PLASTIC, 4M]

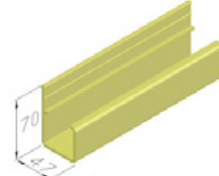

Weight per pc: 3,067kg / Quantity per box: 10pcs

RTG - 2 [ROLLER TRACK GUIDE CENTRE, PLASTIC, 4M]

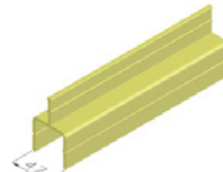

Weight per pc: 2,600kg / Quantity per box: 10pcs

RTG - 3 [ROLLER TRACK GUIDE SIDE OFFSET 40MM, PLASTIC, 4M]

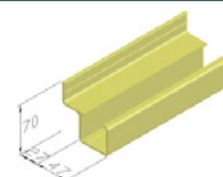

Weight per pc: 3,467kg / Quantity per box: 10pcs

RTG - 4 [ROLLER TRACK GUIDE SIDE OFFSET 40MM, STEEL, 1.5M]

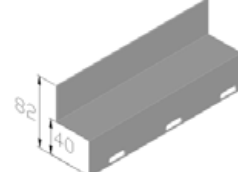

Weight per pc: 1,350kg / Quantity per box: 10pcs

RTG - 4 E [ROLLER TRACK GUIDE SIDE OFFSET 40MM, STEEL, 1.5M, POWDER COATED(ESD)]



Weight per pc: 1,350kg / Quantity per box: 10pcs



Connect
A tube

Mounting Brackets

a product by:



TEXAM
design engineering

GP - A [STANDARD TRACK SUPPORT]

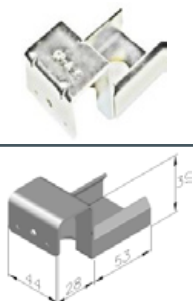

Weight per pc: 0,131kg / Quantity per box: 100pcs

GP - AR [STANDARD TRACK SUPPORT]

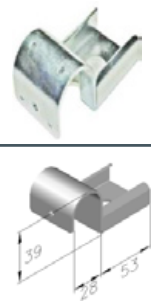

Weight per pc: 0,122kg / Quantity per box: 100pcs

GP - AL [STANDARD TRACK SUPPORT]

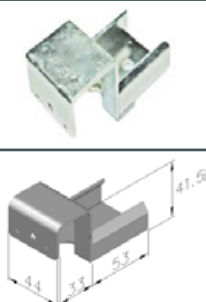

Weight per pc: 0,133kg / Quantity per box: 100pcs

GP - ARL [STANDARD TRACK SUPPORT]



Weight per pc: 0,128kg / Quantity per box: 100pcs

GP - B [ROLLER SUPPORT WITH STOP]

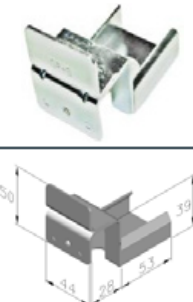
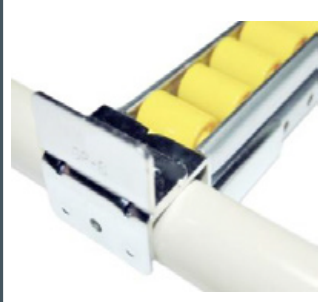

Weight per pc: 0,157kg / Quantity per box: 80pcs

GP - BL [ROLLER SUPPORT WITH STOP]

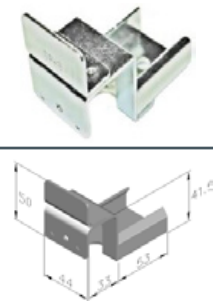
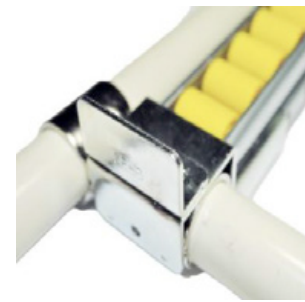

Weight per pc: 0,180kg / Quantity per box: 80pcs

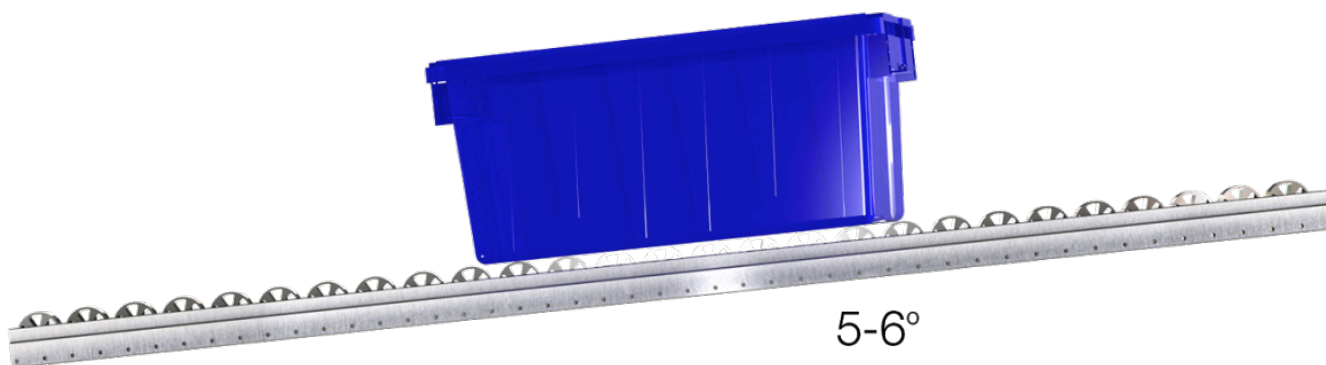

GP – C [ROLLER SPLICE]

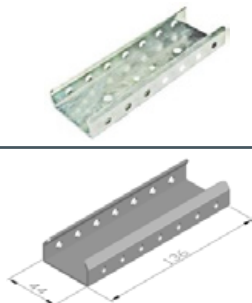

Weight per pc: 0.128kg / Quantity per box: 120pcs

GP – C1 [ROLLER SPLICE WITH CENTRE SUPPORT]

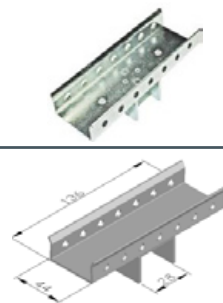

Weight per pc: 0.177kg / Quantity per box: 50pcs

GP – C1L [ROLLER SPLICE WITH CENTRE SUPPORT]

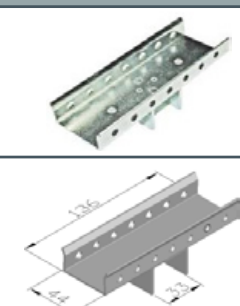

Weight per pc: 0.193kg / Quantity per box: 50pcs

GP – D [ROLLER SUPPORT WITH LARGE STOP]



Weight per pc: 0.142kg / Quantity per box: 80pcs

GP – DL [ROLLER SUPPORT WITH LARGE STOP]

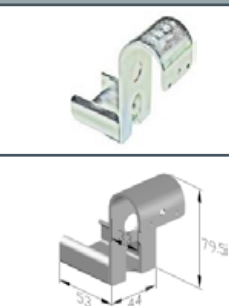

Weight per pc: 0.180kg / Quantity per box: 80pcs

GP – E [ROLLER BRIDGE]

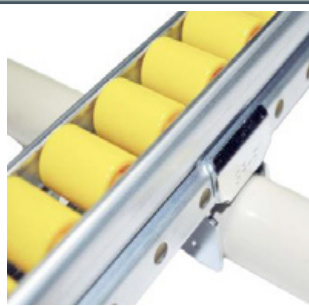

Weight per pc: 0.073kg / Quantity per box: 200pcs

GP – F [STANDARD TRACK SUPPORT - Y STYLE]

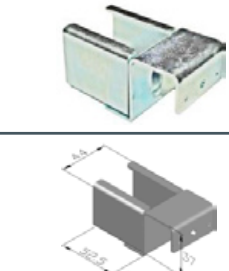

Weight per pc: 0.190kg / Quantity per box: 80pcs

GP – G [STANDARD TRACK SUPPORT-WITH TAB STOP]

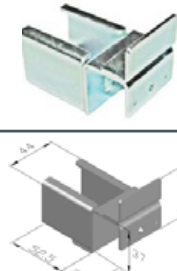
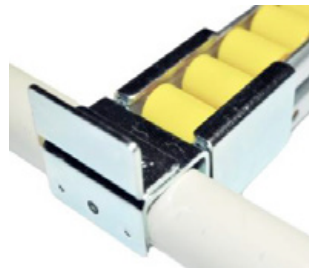

Weight per pc: 0.223kg / Quantity per box: 60pcs

GP – H [ROLLER TO ROLLER SUPPORT]

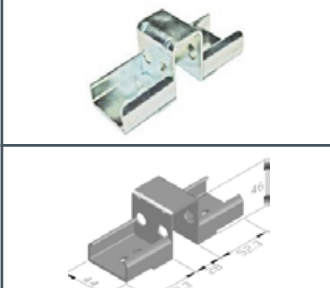

Weight per pc: 0.240kg / Quantity per box: 40pcs

GP – HR [ROLLER TO ROLLER SUPPORT]

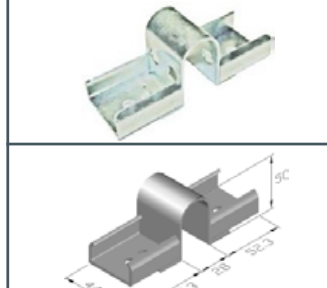
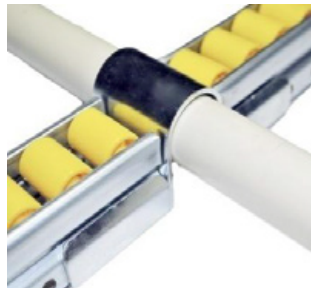

Weight per pc: 0.240kg / Quantity per box: 40pcs

GP – J [ADJUSTABLE ROLLER TO SLIDE PIPE UNION]

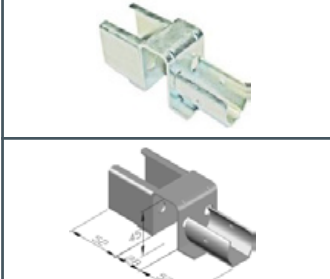

Weight per pc: 0.230kg / Quantity per box: 40pcs

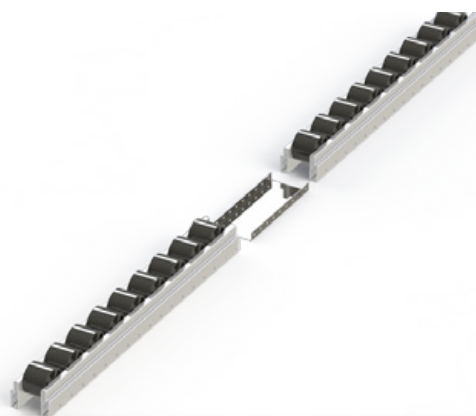

BT– 1

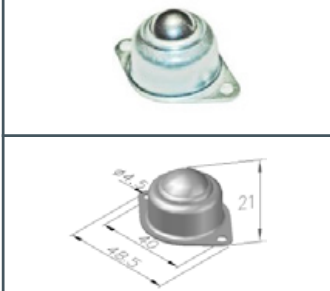
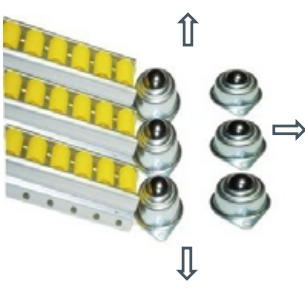

Weight per pc: 0.043kg / Quantity per box: 360pcs

BT– 2

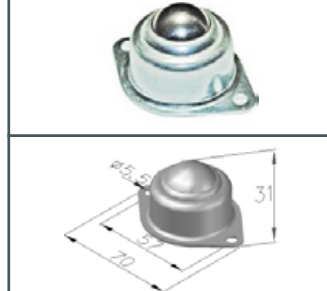
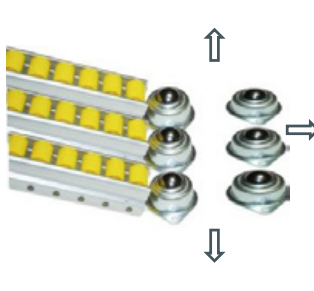

Weight per pc: 0.137kg / Quantity per box: 120pcs

MCP – A – L [MOUNT CORNER PLATE-LEFT]

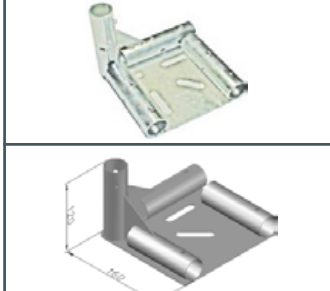

Weight per pc: 1.220kg / Quantity per box: 16pcs

MCP – A – R [MOUNT CORNER PLATE-RIGHT]

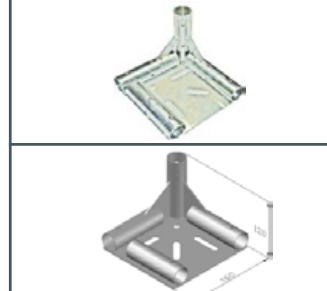

Weight per pc: 1.220kg / Quantity per box: 16pcs

GP – A85 [STANDARD TRACK SUPPORT FOR 85MM WIDE]

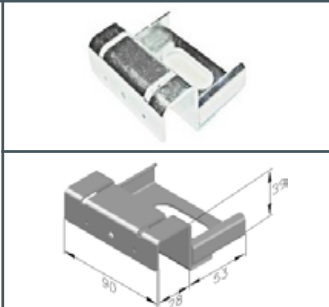

Weight per pc: 0.244kg / Quantity per box: 50pcs

GP – B85 [SUPPORT WITH STOP FOR 85MM ROLLER TRACK]

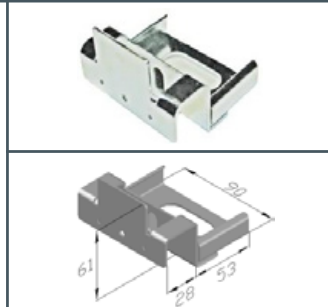
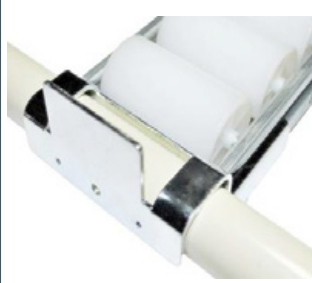

Weight per pc: 0.244kg / Quantity per box: 40pcs

GP – C85 [85MM ROLLER TRACK SPLICE]

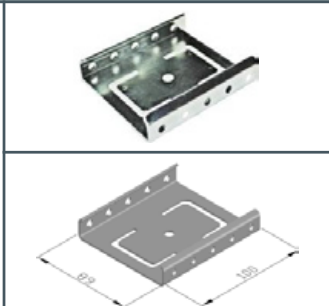

Weight per pc: 0.204kg / Quantity per box: 80pcs

GP-C1-85 [85MM ROLLER SPLICE WITH CENTRE SUPPORT]

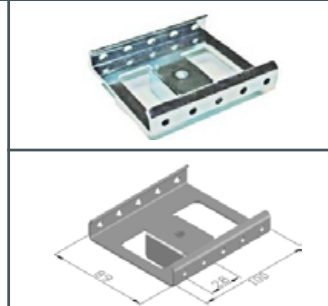
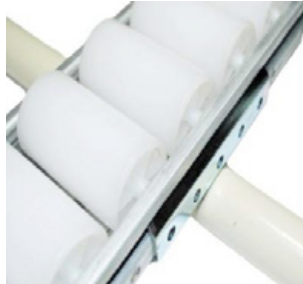

Weight per pc: 0.204kg / Quantity per box: 40pcs

GP-D85 [SUPPORT FOR 85MM ROLLER TRACK]

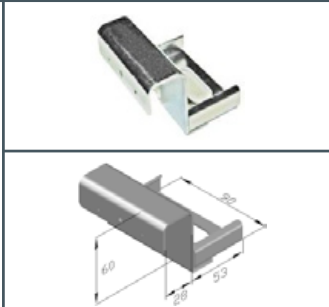
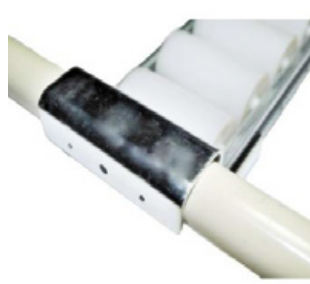

Weight per pc: 0.295kg / Quantity per box: 50pcs

GP – E85 [BRIDGE FOR 85MM ROLLER TRACK]

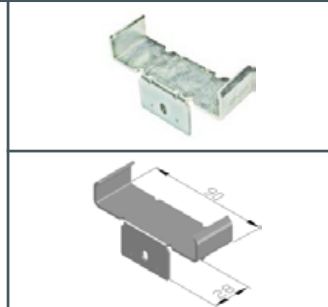

Weight per pc: 0.096kg / Quantity per box: 120pcs

GS – A [SLIDE PIPE SUPPORT]

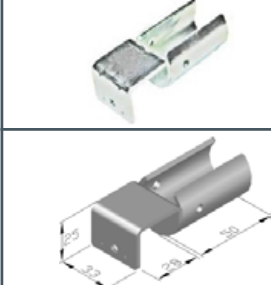

Weight per pc: 0,115kg / Quantity per box: 120pcs

GS – B [SLIDE PIPE SUPPORT WITH STOP]

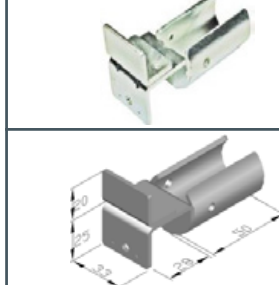

Weight per pc: 0,144kg / Quantity per box: 100pcs

GS – C [SLIDE PIPE UNION]

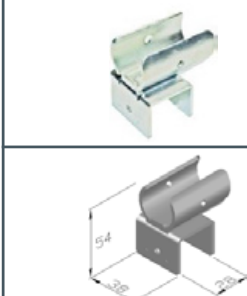

Weight per pc: 0,109kg / Quantity per box: 120pcs

GS– D [SLIDE PIPE SUPPORT WITH DROP STOP]

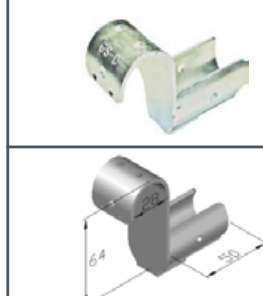

Weight per pc: 0,122kg / Quantity per box: 120pcs

GS – H [SLIDE BRACKET H]

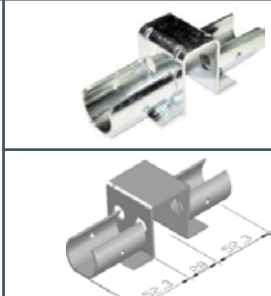

Weight per pc: 0,230kg / Quantity per box: 40pcs



GS – RA [PIPE ROLLER A]

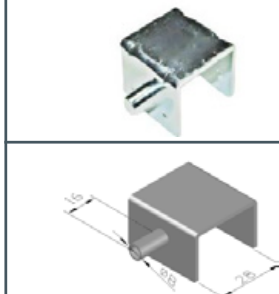

Weight per pc: 0,050kg / Quantity per box: 250pcs

GS – RB [PIPE ROLLER B]

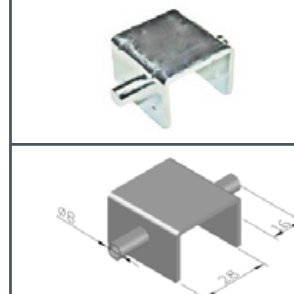
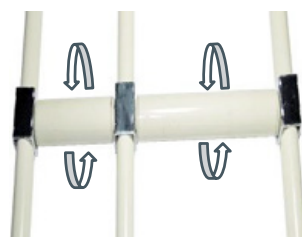

Weight per pc: 0,056kg / Quantity per box: 200pcs



Connect
A tube

Wheels & Castors

a product by:



TEXAM
design engineering



THREAD TYPE

ITEM	DESCRIPTION	WEIGHT PER PC	QUANTITY PER BOX
TT – 50B – M	wheel ϕ 50mm, hole ϕ 11mm, 100kg static load capacity, swivel, brake	0,159 kg	50
TT – 50B – E – M	wheel ϕ 50mm, hole ϕ 11mm, 100kg static load capacity, swivel, brake, ESD	0,159 kg	50
TT – 75B – M	wheel ϕ 75mm, hole ϕ 12,3mm, 150kg static load capacity, swivel, brake	0,267 kg	50
TT – 75B – E – M	wheel ϕ 75mm, hole ϕ 12,3mm, 150kg static load capacity, swivel, brake, ESD	0,249 kg	50
TT – 100B – M	wheel ϕ 100mm, hole ϕ 13mm, 160kg static load capacity, swivel, brake	0,711 kg	24
TT – 100B – E – M	wheel ϕ 100mm, hole ϕ 13mm, 160kg static load capacity, swivel, brake, ESD	0,711 kg	24



THREAD TYPE

ITEM	DESCRIPTION	WEIGHT PER PC	QUANTITY PER BOX
TT – 50S – M	wheel ϕ 50mm, hole ϕ 11mm, 100kg static load capacity, swivel	0,142 kg	50
TT – 50S – E – M	wheel ϕ 50mm, hole ϕ 11mm, 100kg static load capacity, swivel, ESD	0,142 kg	50
TT – 75S – M	wheel ϕ 75mm, hole ϕ 12,3mm, 150kg static load capacity, swivel	0,213 kg	50
TT – 75S – E – M	wheel ϕ 75mm, hole ϕ 12,3mm, 150kg static load capacity, swivel, ESD	0,213 kg	50
TT – 100S – M	wheel ϕ 100mm, hole ϕ 13mm, 160kg static load capacity, swivel	0,552 kg	24
TT – 100S – E – M	wheel ϕ 100mm, hole ϕ 13mm, 160kg static load capacity, swivel, ESD	0,552 kg	24

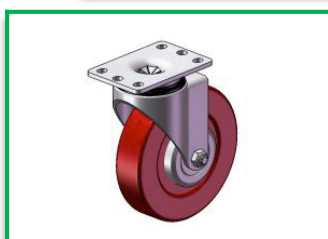
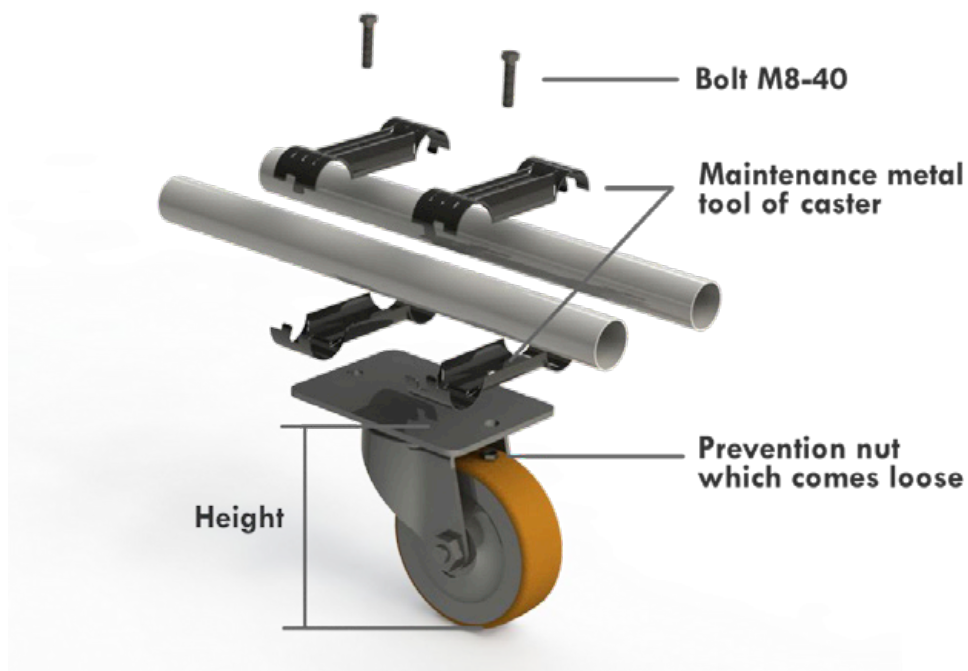
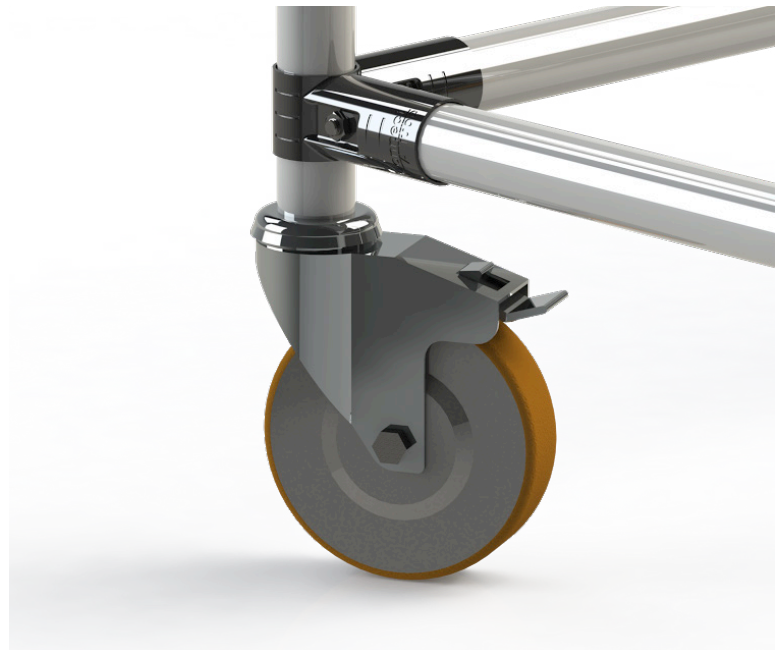
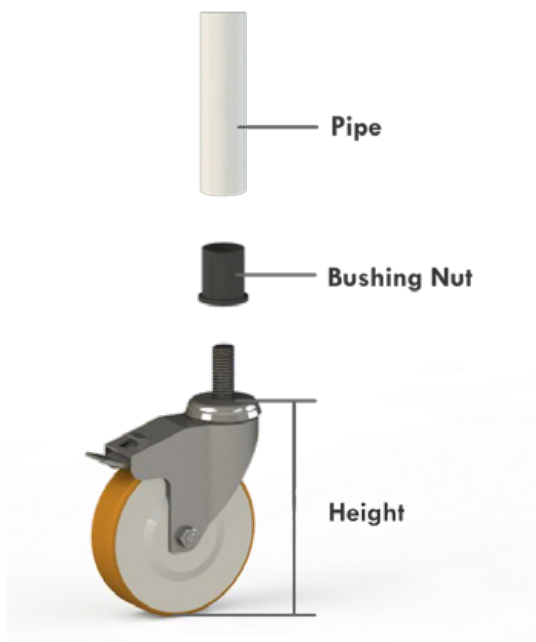

PLATE TYPE			
ITEM	DESCRIPTION	WEIGHT PER PC	QUANTITY PER BOX
PT – 100S	wheel ϕ 100 mm, 160kg static load capacity, swivel	0.583 KG	24
PT – 100S – E	wheel ϕ 100 mm, 160kg static load capacity, swivel, ESD	0.583 KG	24
PT – 125S	wheel ϕ 125 mm, 200kg static load capacity, swivel	0.723 KG	15
PT – 125S – E	wheel ϕ 125 mm, 200kg static load capacity, swivel, ESD	0.723 KG	15
PT – 150S	wheel ϕ 150mm, 200kg static load capacity, swivel	0.915 KG	15
PT – 150S – E	wheel ϕ 150mm, 200kg static load capacity, swivel, ESD	0.915 KG	15
PT – 75B – E	wheel ϕ 75mm, 150kg static load capacity, swivel, brake, ESD	0.299 KG	40
PT – 100B	wheel ϕ 100mm, 160kg static load capacity, swivel, brake	0.766 KG	24
PT – 100B – E	wheel ϕ 100mm, 160kg static load capacity, swivel, brake, ESD	0.766 KG	24
PT – 125B	wheel ϕ 125mm, 200kg static load capacity, swivel, brake	0.903 KG	15
PT – 125B – E	wheel ϕ 125mm, 200kg static load capacity, swivel, brake, ESD	0.903 KG	15
PT – 150B	wheel ϕ 150mm, 200kg static load capacity, swivel, brake	1.087 KG	15
PT – 150B – E	wheel ϕ 150mm, 200kg static load capacity, swivel, brake, ESD	1.087 KG	15
PT – 75R	wheel ϕ 75mm, 150kg static load capacity, rigid	0.160 KG	40
PT – 75R – E	wheel ϕ 75mm, 150kg static load capacity, rigid, ESD	0.160 KG	40
PT – 100R	wheel ϕ 100mm, 160kg static load capacity, rigid	0.483 KG	24
PT – 100R – E	wheel ϕ 100mm, 160kg static load capacity, rigid, ESD	0.483 KG	24
PT – 125R	wheel ϕ 125mm, 200kg static load capacity, rigid	0.626 KG	15
PT – 125R – E	wheel ϕ 125mm, 200kg static load capacity, rigid, ESD	0.626 KG	15
PT – 150R	wheel ϕ 150mm, 200kg static load capacity, rigid	0.830 KG	15
PT – 150R – E	wheel ϕ 150mm, 200kg static load capacity, rigid, ESD	0.830 KG	15





Connect
A tube™

Feet

a product by:



TEXAM
design engineering

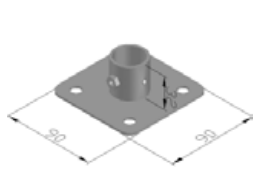

AD – SM [MOUNT, SQUARE]

- WEIGHT PER PC= 0.219KG
- QUANTITY PER BOX= 20 PCS



AD – SMR [MOUNT, SQUARE]

- WEIGHT PER PC= 0.243KG
- QUANTITY PER BOX= 15 PCS

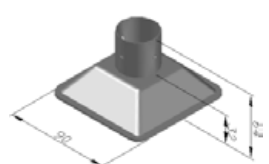

AD – SMS [STANCHION MOUNT, SQUARE]

- WEIGHT PER PC= 0.297KG
- QUANTITY PER BOX= 15PCS



FLOOR LOCK

ITEM	DESCRIPTION	WEIGHT PER PC	QUANTITY PER BOX
FL – 4040	floor lock, for use with 100mm dia, wheel	1.520 kg	8
FL – 4050	floor lock, for use with 125mm dia, wheel	1.540 kg	8
FL – 4060	floor lock, for use with 150mm dia, wheel	1.580 kg	8
FL – 4080	floor lock, for use with 200mm dia, wheel (on request)	1.620 kg	8

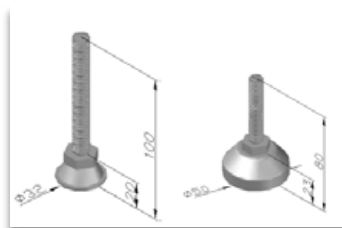

½ " THREAD

ITEM	DESCRIPTION	WEIGHT PER PC	QUANTITY PER BOX
AD – 32 – WB	Adjustable foot, ½" thread, 32mm, metal base 70mm screw, 50mm thread	0.095 kg	300
AD – 32 – WC	Adjustable foot, ½" thread, 32mm, 100mm threaded length	0.110 kg	250
AD – 50 – WA	Adjustable foot, ½" thread, 50mm, metal base 70mm screw, 50mm thread	0.093 kg	200
AD – 50 – WB	Adjustable foot, ½" thread, 50mm, 100mm threaded length	0.130 kg	150
AD – 45	Adjustable foot, ½" thread, 45mm, metal base 50mm screw	0.100 kg	200
AD – 50 – RA	Adjustable foot, ½" thread, 50mm, 50mm threaded length, rubber pad	0.160 kg	120
AD – 50 – RB	Adjustable foot, ½" thread, 50mm, 100mm threaded length, rubber pad	0.175 kg	100

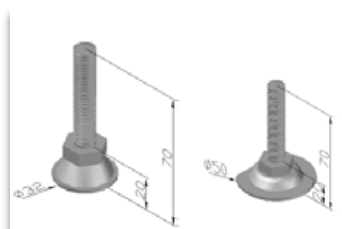

M12 THREAD

ITEM	DESCRIPTION	WEIGHT PER PC	QUANTITY PER BOX
AD-32-WB –M	Adjustable foot, m12 thread, 32mm, metal base 70mm screw, 50mm thread	0.095 kg	300
AD-50-WA –M	Adjustable foot, m12 thread, 50mm, metal base 70mm screw, 50mm thread	0.115 kg	200
AD-45-M	Adjustable foot, m12 thread, 45mm, metal base 50mm screw	0.100 kg	200
AD-50-RA –M	Adjustable foot, m12 thread, 50mm, 50mm threaded length, rubber pad	0.150 kg	150
AD-50-RB –M	Adjustable foot, m12 thread, 50mm, 100mm threaded length, rubber pad	0.180 kg	100
AD-32-WC –M	Adjustable foot, m12 thread, 32mm, 100mm threaded length	0.157 kg	200
AD-50-WB –M	Adjustable foot, m12 thread, 50mm, 100mm threaded length	0.115 kg	200





Connect
A tube™

Caps & Bushings

a product by:

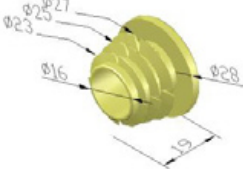
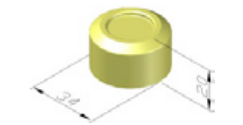

TEXAM
design engineering

CAPS				
	ITEM	DESCRIPTION	WEIGHT PER PC	QUANTITY PER BOX
	CAP-01-BK	Black plastic end cap, fits all pipes	0,003 KG	2500
	CAP-01-EB	ESD Black plastic end cap, fits all pipes	0,003 KG	2500
	CAP-03-IV	ivory plastic outer cap	0,007 KG	2500
	CAP-03-EB	Black plastic outer cap ESD	0,007 KG	2500
	CAP-07-SA	Steel end cap for 0,7mm plastic coated pipe	0,007 KG	1000
	CAP-07-SB	Steel end cap for 0,7mm stainless steel or powder coated pipe	0,007 KG	1000
	CAP-08-S	Steel end cap for 0,8 mm powder coated pipe	0,070 KG	1000
	CAP-10-S	Steel end cap for 1,0mm plastic coated pipe	0,007 KG	1000
	CAP-11-S	Steel end cap for 1,1mm stainless steel or powder coated pipe	0,007 KG	1000
	CAP-12-S	Steel end cap for 1,2mm stainless steel or powder coated pipe	0,007 KG	1000
	CAP-20-S	Steel end cap for 2,0mm plastic coated pipe	0,070 KG	1000

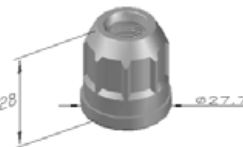
BUSHINGS				
	ITEM	DESCRIPTION	WEIGHT PER PC	QUANTITY PER BOX
	BS - 2807 - A	Bushing nut, M12-1/2" thread, for 0,7mm plastic coated	0,080 KG	300
	BS - 2807 - B	Bushing nut, M12 thread, for 0,7mm plastic coated pipe	0,080 KG	300
	BS - 2807 - D	Bushing nut, M12 thread, for 0,7mm stainless steel or powder coated pipe	0,095 KG	300
	BS - 2808 - A	Bushing nut, M12-1/2" thread, for 0,8mm powder coated pipe	0,083 KG	300
	BS - 2808 - B	Bushing nut, M12 thread, for 0,8mm powder coated pipe	0,083 KG	300
	BS - 2810 - A	Bushing nut, M12-1/2" thread, for 1,0mm plastic coated pipe	0,073 KG	300
	BS - 2810 - B	Bushing nut, M12 thread, for 1,0mm plastic coated pipe	0,073 KG	300
	BS - 2810 - F	Bushing nut, M12 thread, for 1,0mm pipe	0,083 KG	300
	BS - 2812 - A	Bushing nut, M12-1/2" thread, for 1,2mm stainless steel or powder coated pipe	0,077 KG	300
	BS - 2812 - B	Bushing nut, M12 thread, for 1,2mm stainless steel or powder coated pipe	0,077 KG	300
	BS - 2820 - A	Bushing nut, M12-1/2" thread, for 2,0mm pipe	0,065 KG	300
	BS - 2820 - B	Bushing nut, M12 thread, for 2,0mm pipe	0,065 KG	300

Connect
A tube

Fasteners

a product by:



TEXAM
design engineering

BOLTS				
	ITEM	DESCRIPTION	WEIGHT PER PC	QUANTITY PER BOX
	M0625	M6 bolt, 25mm long	0,007 KG	4000
	M0625L	M6 bolt, 25mm long, self locking	0,007 KG	4000
	M0610	M6 bolt, 10mm	0,004 KG	5000

● YE = YELLOW

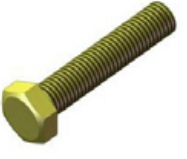
BOLTS				
	ITEM	DESCRIPTION	WEIGHT PER PC	QUANTITY PER BOX
	M835 - Y	M8 bolt, 35mm long, yellow steel	0,017 KG	1000
	M840 - Y	M8 bolt, 40mm long, yellow steel	0,018 KG	1000
	M850 - Y	M8 bolt, 50mm long, yellow steel	0,021 KG	1000

SCREWS				
	ITEM	DESCRIPTION	WEIGHT PER PC	QUANTITY PER BOX
	SC - 1	self cutting screw, 3,5 x 13mm, x-head, for use with metal	0,002 KG	5000
	SC - 2	self cutting screw, 4,0 x 20mm, x-head, for use with metal	0,002 KG	5000

NUTS

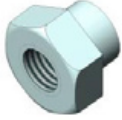
	ITEM	DESCRIPTION	WEIGHT PER PC	QUANTITY PER BOX
	TN06	M6 T – nut	0,002 KG	10000
	TN06L	M6 T – nut, self locking	0,002 KG	10000

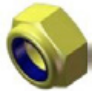

 YE = YELLOW

NUTS

	ITEM	DESCRIPTION	WEIGHT PER PC	QUANTITY PER BOX
	NN08 – Y	Nut, m8, yellow steel with nylon insert	0,005 KG	3000



WASHERS

	ITEM	DESCRIPTION	WEIGHT PER PC	QUANTITY PER BOX
	PW10 – Y	M10 Flat washer	0,002 KG	5000
	PW12 – Y	M12 Flat washer	0,002 KG	5000
	SW10 – Y	M10 Spring washer	0,002 KG	5000
	SW12 – Y	M12 Spring washer	0,002 KG	5000



Construction Guide

a product by:



TEXAM
design engineering

Using Connect-A-Tube

Good manufacturing ideas often evolve in to better ideas and so a process of continual improvement is required. Continual improvement requires using a product that is economic to use, quick to assemble, and easy to change. Connect-A-tube is an ideal product that allows manufacturers to do all of these things. If radical changes are required all equipment assembled using Connect-A-tube can be totally dismantled and reconfigured using the same parts time and time again.

Connect-A-tube is an ideal aid to manufacturing processes requiring workstations, carts and trolleys, packing stations, simple conveyor systems, flow racks etc. Although the product is very strong we recommend that the product is only used in manual loading and unloading operations. The system is not designed for the construction of heavy pallet type racking or anything that would be loaded with a fork lift truck.

Connect-A-tube is primarily designed to facilitate manual type operations where product handling can be reduced or made more ergonomically friendly.

www.connect-a-tube.com

Key Advantages

1. Simplicity

The product is simple to use and requires no special tools or technical design ability. In many cases operators themselves can use Connect-A-tube to solve their own materials handling issues and improve their working practices.

2.

Economical

Connect-A-tube is very economical to use. All of the pipes and joints can be deconstructed and reassembled to create new products time and time again. Designing new products is simple and only basic tools are required to assemble it. Connect-A-tube is also a very competitive product to use when compared to using aluminium profiles.

3. Space Saving and Ergonomics

Connect-A-tube is designed to provide users with the ability to construct products that maximise the use of space and are ergonomically designed to keep workers comfortable and safe.

4.

Flexibility

Connect-A-tube allows its users to create products that are totally flexible. It's easy to add new sections, integrate other options or simply disassemble and reassemble in to something completely different.

How do I calculate pipe sizes and lengths?

Desired overall length (1000mm) - (A(16.5mm) + B(35mm))2 = C Pipe length needed (897mm)

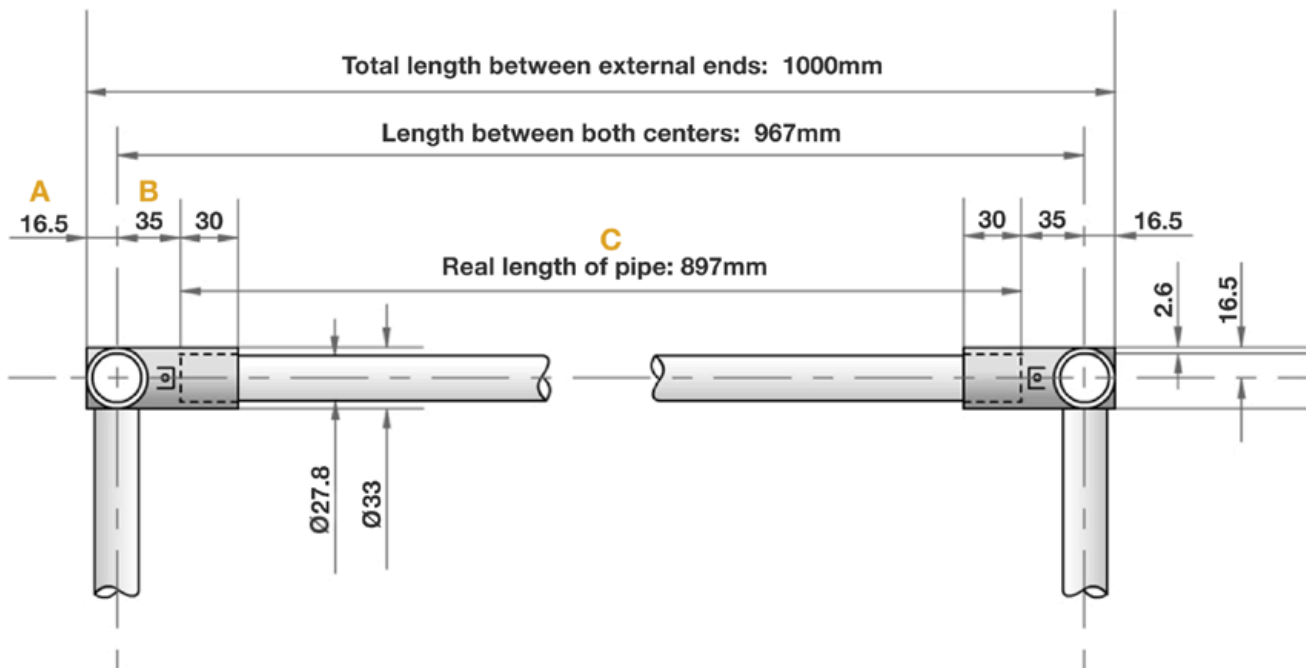

There are 2 basic methods that can be used to calculate the cut length of a required pipe:

Option 1

Calculating the required length of a pipe where the design is using the pipe centres as the required measurement.

Take the overall centre distance and subtract 70mm. In the example shown above the cut pipe length would be 897mm.

Option 2

Calculating the required length of a pipe where the design is using the overall width of the structure including any brackets as the required measurement.

Take the overall length or width of the structure to be assembled and subtract 103mm. In the example shown above the cut pipe length would again be 897mm.

Pipe Strength

Just like any other fabricated structure the overall strength and stability of any assembled piece of equipment depends on the design, components used and the build quality. Incorrectly assembled joints will not perform correctly and a lack of structural support will lead to poor stability. It is important to consider the weight that any assembled piece of equipment will need to support and whether or not the equipment will be permanently static or mobile.

The information below will help you to determine how many brackets and what supports will be necessary to construct a safe piece of working equipment based on the maximum loading that the pipes and joints will support.

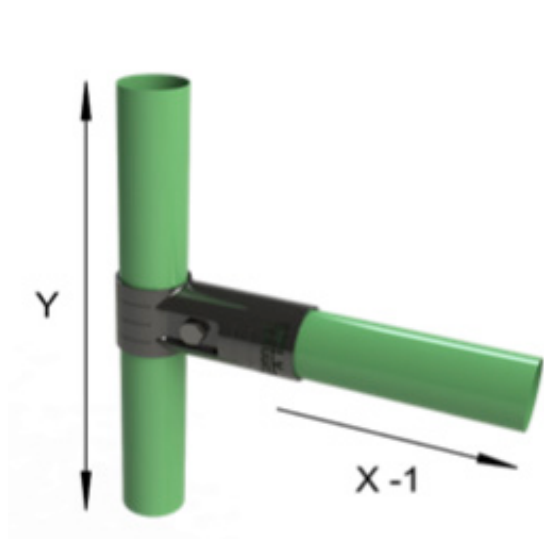

X1 = 75Kgs Y = 85Kgs Using Plastic Coated Pipes
X1 = 60Kgs Y = 70Kgs Using Stainless Steel Pipes

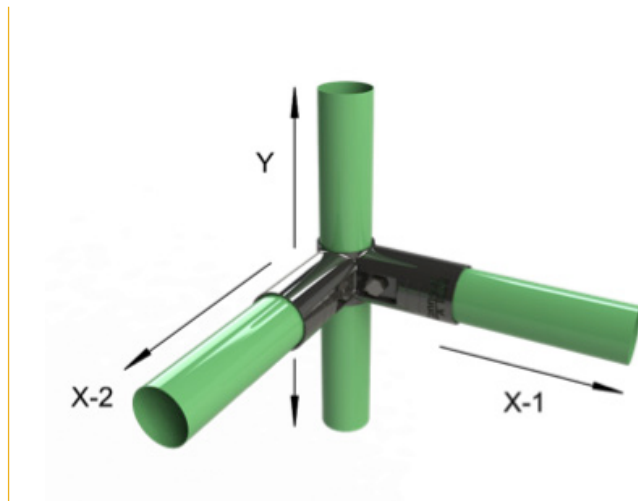

X1 = 75Kgs X2 = 60Kgs Y = 85Kgs Using Plastic Coated Pipes
X1 = 30Kgs X2 = 30Kgs Y = 70Kgs Using Stainless Steel Pipes

Maximum Pipe Loadings

Distance Between Pipe Centres	Tube Wall Thickness 1.0mm	Tube Wall Thickness 2.0mm	Stainless Steel Tube 1.2mm
1.0m	68kgs	150kgs	68kgs
1.25m	55kgs	123kgs	55kgs
1.50m	46kgs	100kgs	46kgs
1.75m	39kgs	88kgs	39kgs
2.0m	34kgs	75kgs	34kgs

Some Do's & Don't's

✗ Incorrect



✓ Correct



✗ Incorrect



✓ Correct

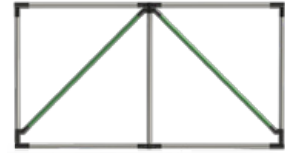

✗ Incorrect

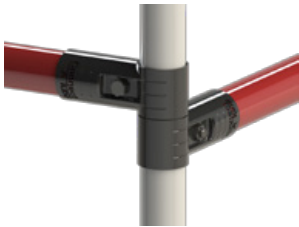

✓ Correct



✗ Incorrect

Structure at the top of the picture showing Incorrect

✓ Correct

Structure at the bottom of the picture showing Correct

✗ Incorrect



✓ Correct



✓ Correct



✓ Correct



Connect A tube™

Designed by Positive Design Consultants

Endless Possibilities™



TEXAM
design engineering

Texam Limited
Altona Road
Blaris Industrial Estate
Lisburn, Co. Antrim
BT27 5QB

Tel
+44 (0)28 9267 4137
Fax
+44 (0)28 9260 7238

www.texam.co.uk

www.connect-a-tube.com